

THESE DRAWINGS AND SPECIFICATIONS ARE THE PROPERTY OF JBL INCORPORATED.
THEY ARE ISSUED IN STRICT CONFIDENCE AND SHALL NOT BE REPRODUCED OR USED
AS THE BASIS FOR MANUFACTURE OR APPARATUS WITHOUT WRITTEN PERMISSION.

REVISIONS						
CHG	LTR	DESCRIPTION	DRFT	D.C	DATE	APPR
	A	RELEASE TO MARKETING	A			

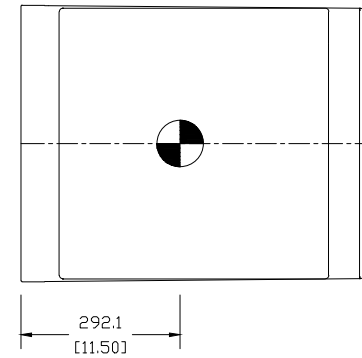
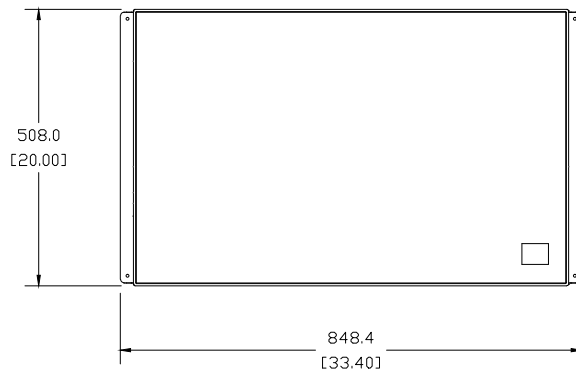
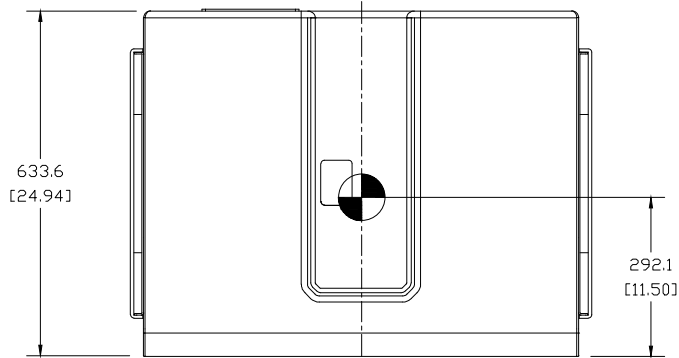

1. COMPONENTS: LF: 2X 2275H
2. INPUT CONNECTORS: 2 TERMINAL BARRIER STRIP ON BACK.
JUMPER TERMINAL CUP ON TOP AND BOTTOM.
3. GRILL: 16 GA. PERFORATED CRS, POWDERCOATED, GRAY CLOTH BACKING.
4. MATERIALS: FIBER GLASS.
5. FINISH: GELCOAT
6. SUSPENSION POINTS: 14X M10 PER SIDE.
7. WEIGHT: 56.7 kg (125 LBS)

⑧ CENTER OF GRAVITY (CG)

NOTES: (UNLESS OTHERWISE SPECIFIED)

TOLERANCES (UNLESS OTHERWISE SPECIFIED)	
XXX	± .063 INCH
XX	± .125 INCH
ANGULAR TOLERANCE OF 0°±30'	
FRACTIONAL DIMENSIONS ± 1/32	
* DIMENSIONS ARE INCHES	
* ALL DIMENSIONS ARE FINISHED DIMENSIONS	
* DO NOT SCALE DRAWING	

JBL PROFESSIONAL A Harman International Company Northridge, California 91329 U.S.A.	
TITLE CUSTOMER DWG VLA-C125S	
SIZE A	DRAWING NO. 1000322288
SCALE NTS	REV A
SHEET 1 OF 3	

THESE DRAWINGS AND SPECIFICATIONS ARE THE PROPERTY OF JBL INCORPORATED. THEY ARE ISSUED IN STRICT CONFIDENCE AND SHALL NOT BE REPRODUCED OR USED AS THE BASIS FOR MANUFACTURE OR APPARATUS WITHOUT WRITTEN PERMISSION.

REVISIONS						
CHG	LTR	DESCRIPTION	DRPT	D.C	DATE	APPR
	A	RELEASE TO MARKETING	A			

SHOWN WITHOUT SIDE COVER

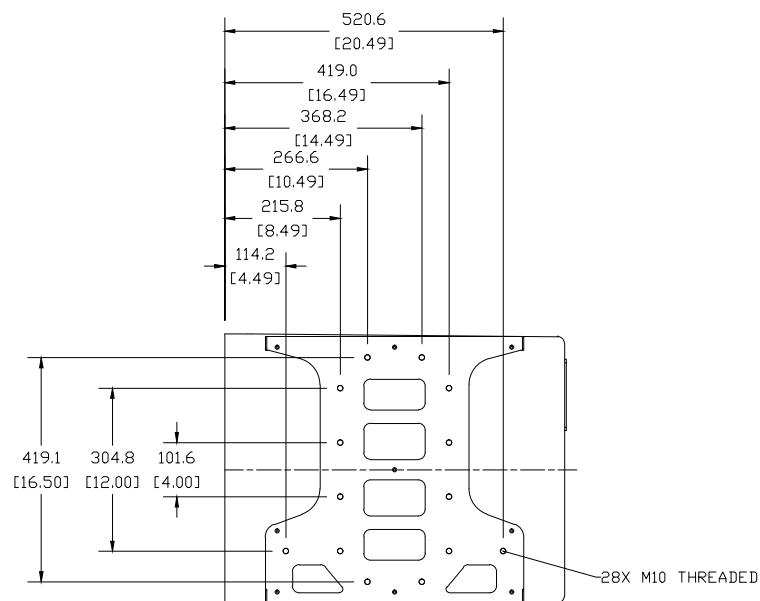
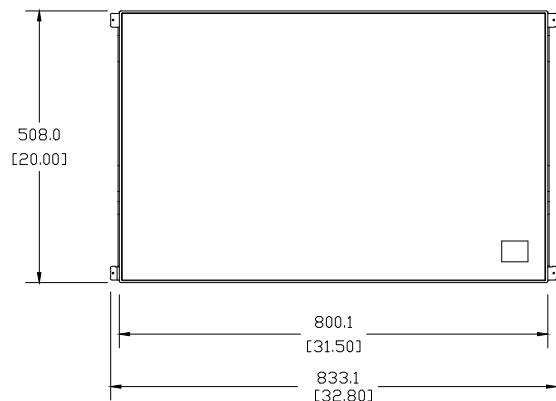
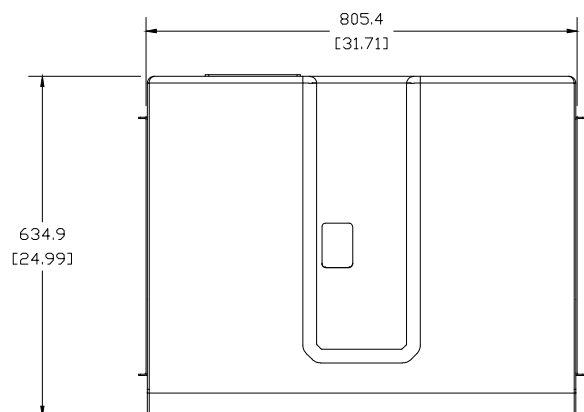

NOTES: (UNLESS OTHERWISE SPECIFIED)

		JBL PROFESSIONAL A Harman International Company Northridge, California 91329 U.S.A.	
TITLE		CUSTOMER DWG VLA-C125S	
SIZE	DRAWING NO.	REV	
A	1000322288	A	
SCALE NTS		SHEET 2 OF 3	

THESE DRAWINGS AND SPECIFICATIONS ARE THE PROPERTY OF JBL INCORPORATED. THEY ARE ISSUED IN STRICT CONFIDENCE AND SHALL NOT BE REPRODUCED OR USED AS THE BASIS FOR MANUFACTURE OR APPARATUS WITHOUT WRITTEN PERMISSION.

REVISIONS						
CHG	LTR	DESCRIPTION	DRPT	D.C	DATE	APPR
	A	RELEASE TO MARKETING	A			

SHOWN WITHOUT SIDE BRACKET & COVER

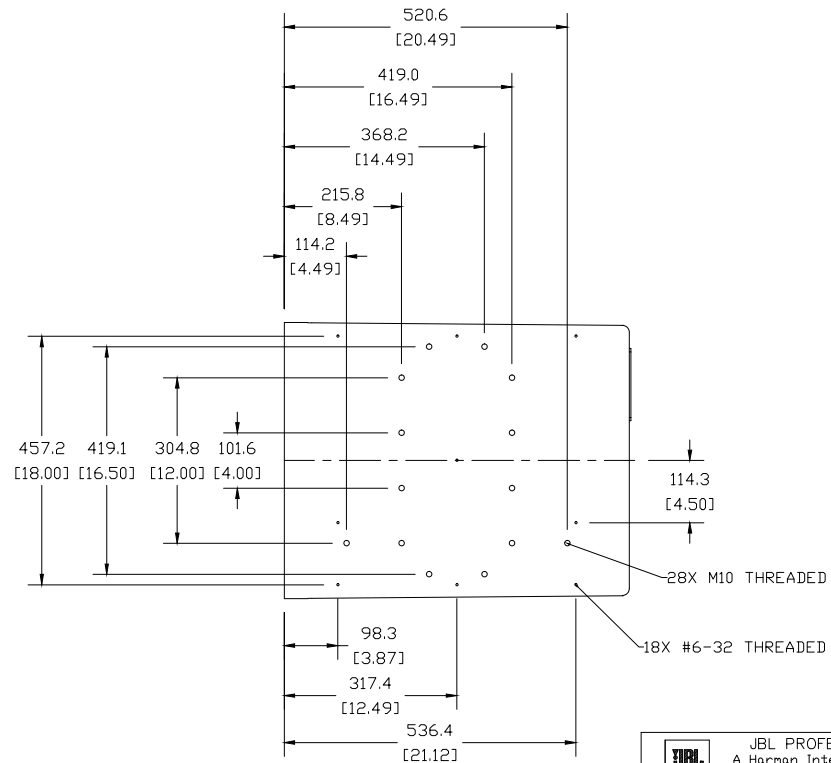
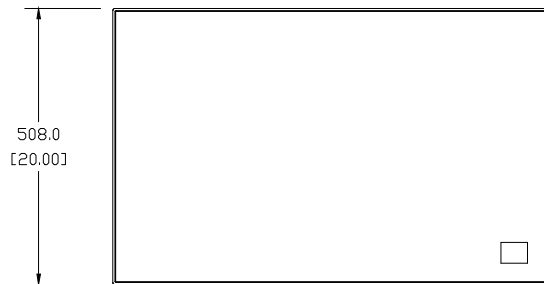
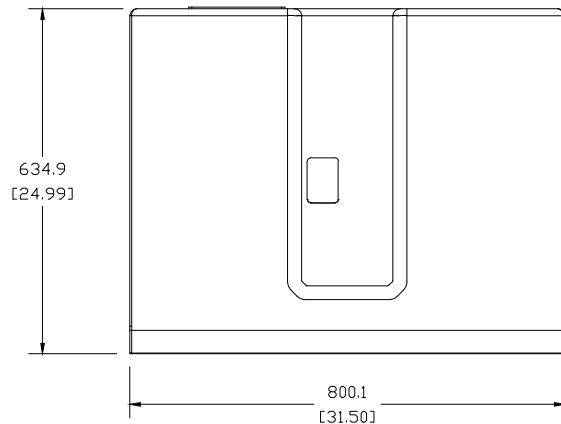

NOTES: (UNLESS OTHERWISE SPECIFIED)

JBL JBL PROFESSIONAL A Harman International Company Northridge, California 91329 U.S.A.			
TITLE		CUSTOMER DWG VLA-C125S	
SIZE	DRAWING NO.	REV	
A	1000322288	A	
SCALE NTS		SHEET 3	OF 3